

# Perma-Grip

UMI - Body Specifications

## Internally Expanded Permanent Hose Couplings

Male Specifications								
Size	Part #	A	B	C	D	E	F*	WT
3/4"	75M	0.84	0.25	1.04	2.14	0.75	1.50	0.22
1"	100M	0.95	0.25	1.19	2.39	0.99	1.81	0.35
1"	100M-NST	0.63	0.25	1.19	2.06	0.99	1.81	0.29
1-1/4"	125M	1.00	0.28	1.50	2.78	1.24	2.12	0.56
1-3/8"	137M	1.00	0.31	1.78	3.10	1.37	2.37	0.73
1-1/2"	150M	1.00	0.31	1.78	3.10	1.49	2.37	0.73
2"	200M	1.00	0.37	2.12	3.49	1.99	3.00	1.09
2-1/2"	250M	1.37	0.50	2.52	4.39	2.49	3.50	1.79
3"	300M	1.50	0.62	2.77	4.89	2.99	4.06	2.82
4"	400M	1.73	0.59	4.62	6.94	4.00	5.48	5.40

Estimated weight of coupling is in pounds.  
 \*F is the measurement across the octagon flats.  
 Male couplings are tested and certified to A.P.I. 1529 and British Standard EN-1361. 3/4", 1" NST and 1-3/8" are not API sizes.

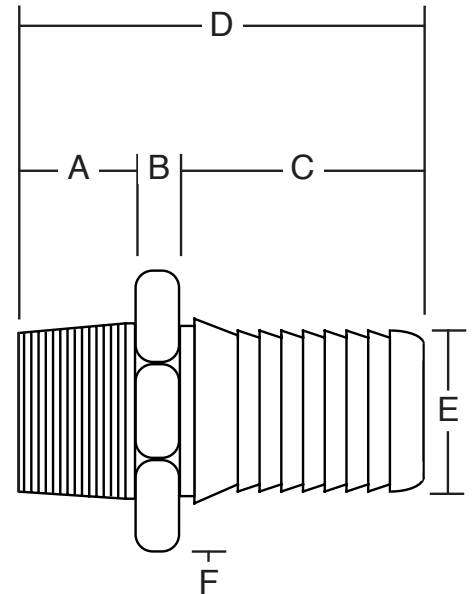

Female Specifications									
Size	Part #	A	B	C	D	E	F*	G*	WT
3/4"	75F	0.75	0.25	1.04	2.20	0.75	1.50	1.30	0.32
1"	100F	0.95	0.25	1.19	2.39	0.99	1.81	1.44	0.42
1"	100F-NST	1.00	0.25	1.19	2.44	0.99	1.81	1.63	0.52
1-1/4"	125F	1.01	0.28	1.50	2.79	1.24	2.12	1.87	0.66
1-3/8"	137F	1.19	0.31	1.78	3.28	1.37	2.37	2.12	0.92
1-1/2"	150F	1.19	0.31	1.78	3.28	1.49	2.37	2.12	0.92
2"	200F	1.22	0.37	2.12	3.71	1.99	3.00	2.62	1.44
2-1/2"	250F	1.56	0.50	2.52	4.58	2.49	3.50	3.25	2.65
3"	300F	1.69	0.62	2.77	5.08	2.99	4.06	4.00	4.08
4"	400F	1.75	0.59	4.62	6.96	4.00	5.48	5.00	7.25

Estimated weight of coupling is in pounds.  
 Nut on the 75F and 100F is a hexagon. All others are octagon.  
 \*F and G are the measurement across the flats.  
 Female couplings are tested and certified to A.P.I. 1529 and British Standard EN-1361.  
 3/4", 1" NST and 1-3/8" are not API sizes.

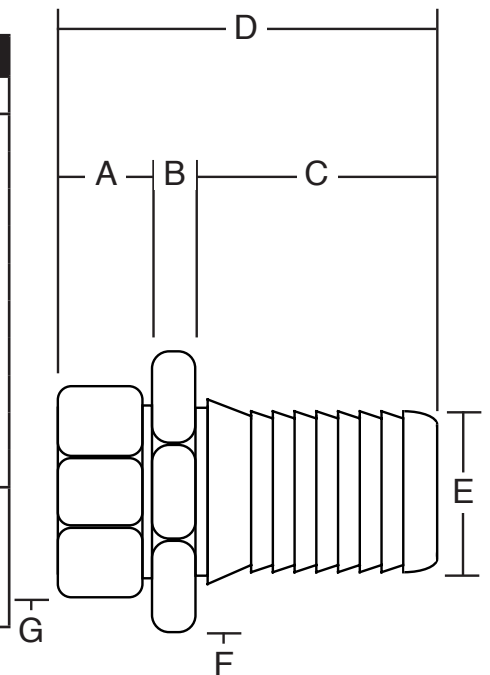

Do not mix UMI coupling components with those produced by other manufacturers.